

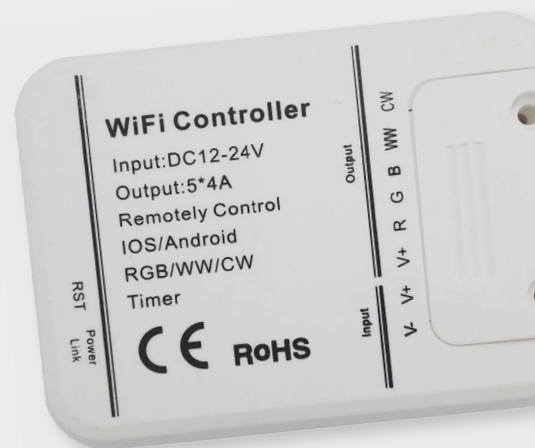

RECTANGULAR
WIFI
CONTROLLER (V2)

OPERATING INSTRUCTIONS



The elegant way of expressing your own style.





FUNCTIONAL OVERVIEW

The RGBW LED WiFi control allows you to control the RGBW LED lighting of your adeco entrance door panel via smartphone or tablet.

This control is also compatible with Amazon Alexa, Google Assistant or IFTTT Applets.

- The required app "Magie Horne Pro" is available for free download in the Apple store and Google Play store.
- This app is available for the operating systems iOS 9.0 or Android 4.0 or higher.
- The controller can either be used as a standalone controller (setting up its own wireless LAN) or be integrated in your in-house network.
- The controller is equipped with a timer function, enabling you to set a certain time to switch the LED lighting on or off.
- This timer function can be programmed with repetitions, depending on the days of the week.
- The timer function will be deleted in the event of power failure.
- The controller enables you to adjust the colours, the brightness and individual colour sequences.
- A number of controllers can be put together in one group and activated synchronously.
- The controllers in one group can also be activated individually.
- Thanks to a remote function, the controller can also be activated while you are on your way.
- Using the remote function does not allow you to activate groups, you can only activate individual controllers.
- The controller is equipped with a memory function, so that the previous settings are kept in the event of power failure - with the exception of the timer function.
- Individual colour sequences can be created, including the speed and mode of the change of colour and the individual colours.
- The controller has a music function, adapting the lighting to the music. However, this function cannot yet be described as technically mature.
- Max. power supply: 4A per channel
- Max. output: RGBW LED stripe: 192W with 12V
- Functions: on-off, brightness, colours, 20 pre-defined colour sequences, individual programming of colour sequences, timer function, remote function, grouping, (music function)
- Max. operating range to router (network) or smartphone (standalone operation): 30m
- Dimensions (L x H): 70mm x 23mm



Reset

In order to reset the controller, please use the pin supplied and press the reset button at the "RST" opening for approx. 10 seconds.

The controller starts flashing all colours and all settings are deleted.



RESET



CONNECTING THE CONTROLLER

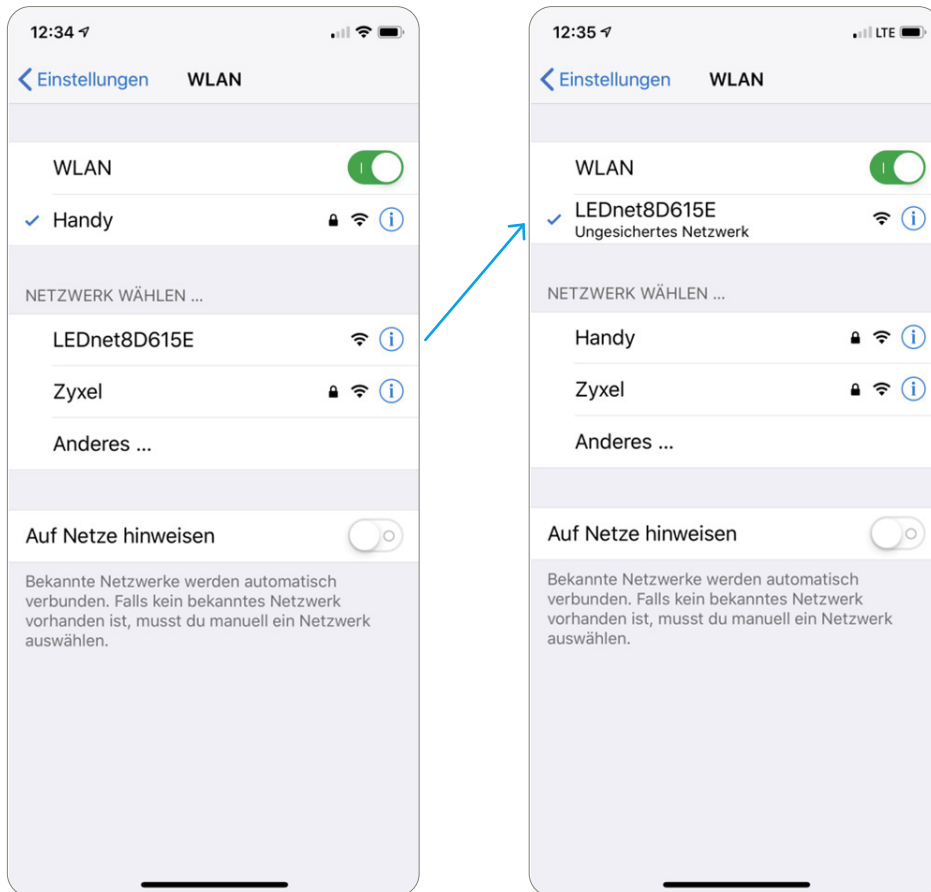

Connecting the controller with the smartphone (here: iPhone)

- Supply 10.8 to 12 volt direct current to controller (use power supply unit provided)
- Select network (LEDnetxxxxxxx) of the controller under settings → WLAN → and connect to network



START SCREEN

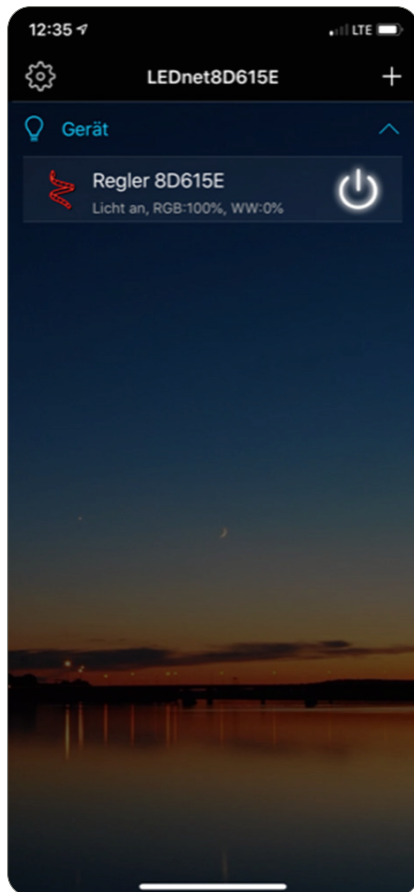

Start screen

- Open app „Magic Home Pro“
- The connected controller is shown under "device"
- The controller can be switched on and off via the " On-Off" symbol on the right
- Clicking on the connected controller will lead you to the main menu (page after next)



SELECT MODE

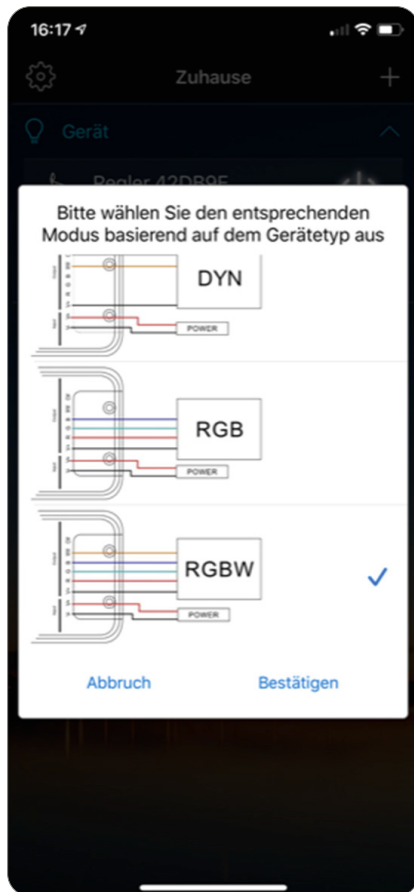

Select mode (only when connecting for the first time)

When connecting for the first time, a menu for the mode appears. Please select "RGBW".

You will possibly have to scroll down to find this mode.

Click on "Confirm" to save the setting.



MAIN MENU



Main menu (function "Colours")

- The controller can be switched on or off at the top right
- The "Clock" leads you to the timer menu (page after next)
- Adjust any colour shade for the LEDs via the colour wheel
- Adjust the brightness using the slider
- You can also define an exact colour by entering a number at the top left under "RGB" (if a number of objects shall have identical lighting)
- To select the function of the controller, use the menu bar at the bottom



MAIN MENU



Main menu (function „Warm“)

- The controller can be switched on or off at the top right
- The " Clock" leads you to the timer menu (next page)
- Adjust any brightness for the warm-white LEDs using the wheel
- Use the black circle to switch the warm-white LEDs off, and the yellow to switch them on (100%)
- The brightness is shown as a percentage at the top left
- To select the function of the controller, use the menu bar at the bottom



TIMER MENU

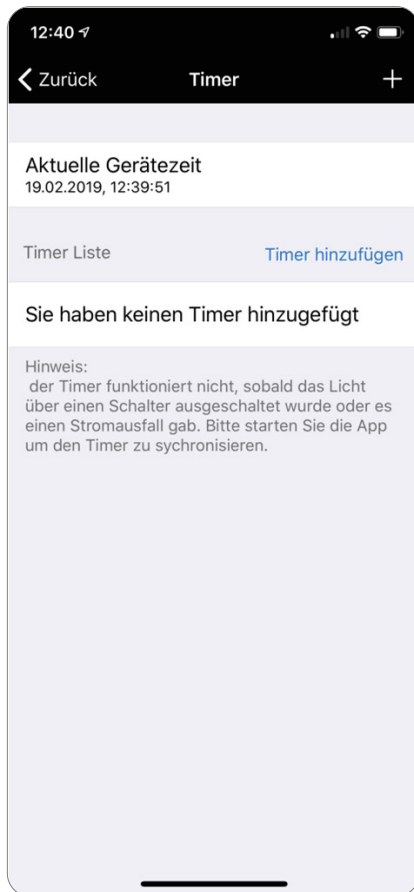

Timer Menu

- Click on "Add timer" to create a timer
- Select a cycle time under "Time"
- Use "Repeat" to define the days you wish to activate the timer
- "ON/OFF" defines whether the lighting shall be switched on or off by the timer you created
- Use "Mode" to customize the colour and intensity of this timer
- Save your settings under "Save" at the top right



TIMER MENU



Timer Menu

- Adjust a timer for switching on
- Adjust a timer for switching off
- Slide the blue switch on the right to activate or deactivate the timers listed

Attention: timers are automatically deleted in the event of power failure!



SECURITY SETTINGS

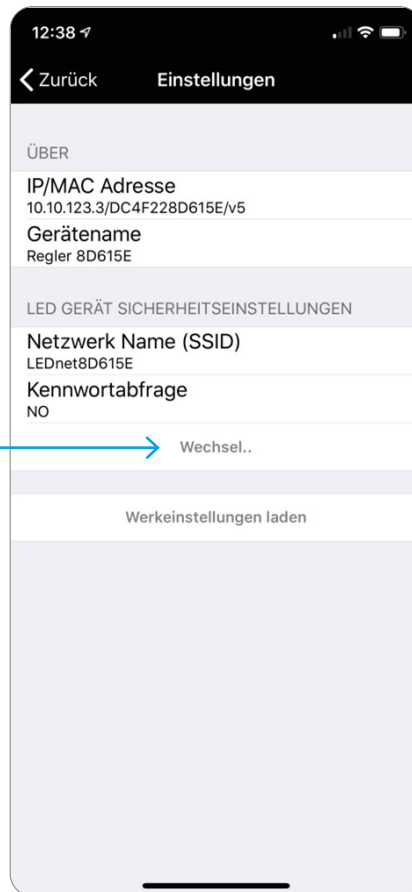
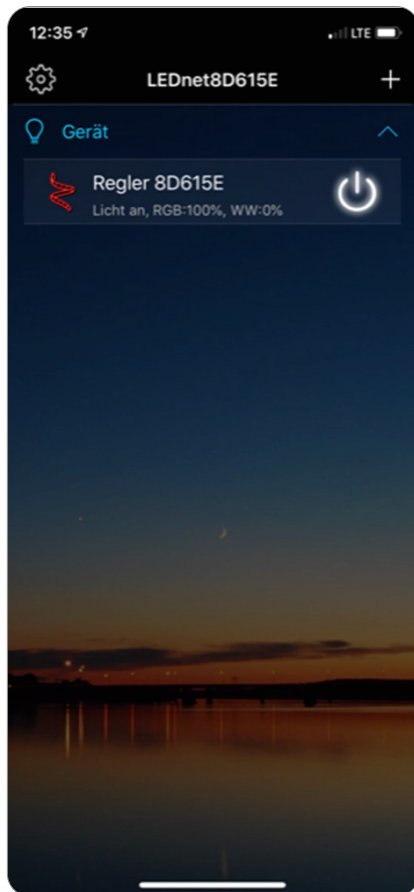

Security settings

- Use the gear icon at the top left of the start screen to go to the security settings
- Click on "Change" to access the "Password menu"



PASSWORD MENU

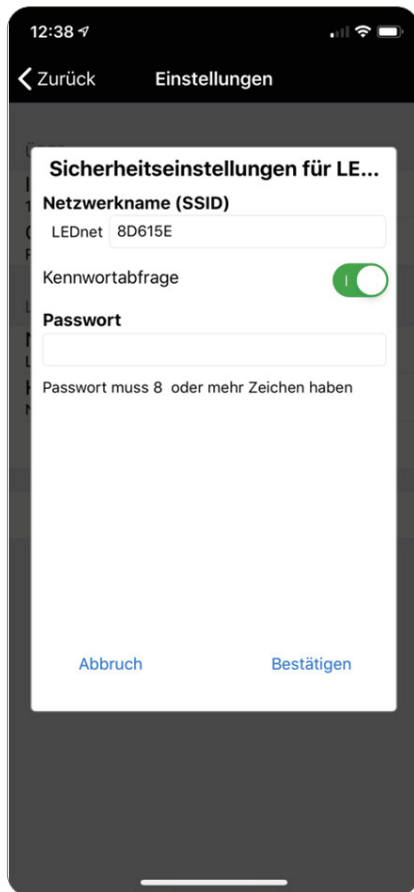

Password menu

- Slide the switch „Password required“ to the On position and a field will open to enter a password
- Your individual password requires at least 8 digits
- Click on “Confirm” to save your settings